

LEGEND:-
--- Existing structure to be demolished.
--- Existing walls to be retained.
--- New non-loadbearing stud walls.

Method Statement 1:-

1. Prop existing rotten beams. Position props at a maximum of 1.5m from rotten ends of beams. Jack up plyweb beams to original ceiling level.
2. Remove external wall from Grid A/13 to16.
3. Cut out decay & repair plyweb beams as shown.
4. Break out ground floor finishes locally to create recess for new column base.
5. Ensure beams are level.
6. Position columns & fix to existing slab & to repaired beams. Provide packing & level as required.
7. Make good existing slab finishes at base of columns.
8. Fix new ply decking to top of existing beams/battens.
9. Place insulation & finishes in accordance with the Architects specification.

Method Statement 2:-

1. Construct new partition (50x100 C24 studs @ 400 c/c) & fix to underside of existing timber roof trusses to provide restraint to top of partition wall.
2. Remove existing glazed stud wall on Grid Line D.

FOR TENDER

T1	TENDER ISSUE:	28.11.18	KGD	MB
P1	PRELIMINARY ISSUE:	28.11.18	KGD	MB
Revision	Amendments	Date	Rev'd	Ch'd
K.G.Denyer. 28.11.2018 STRUCT				

ctp consulting engineers

Suffolk House 154 High Street
Sevenoaks Kent TN13 1XE UK
UK: +44 (0)1732 740195
Malta: +356 2778 0051
www.ctp-lp.com

Project Title:

RED CROSS BUILDING
BRADBOURNE VALE ROAD
SEVENOAKS, KENT.

Drawing Title:

GROUND FLOOR PLAN
SHOWING STRUCTURE OVER.

Drawing Number:

A5720-001

Scale
1:50 @A1
Unless Noted Otherwise
Revised

CDM 2015 RESIDUAL RISKS

- 1.
- 2.
- 3.
- 4.

The above residual risks are for non-standard hazards. It is assumed that a competent contractor familiar with the construction of this type of work will be appointed who will be aware of the standard hazards.

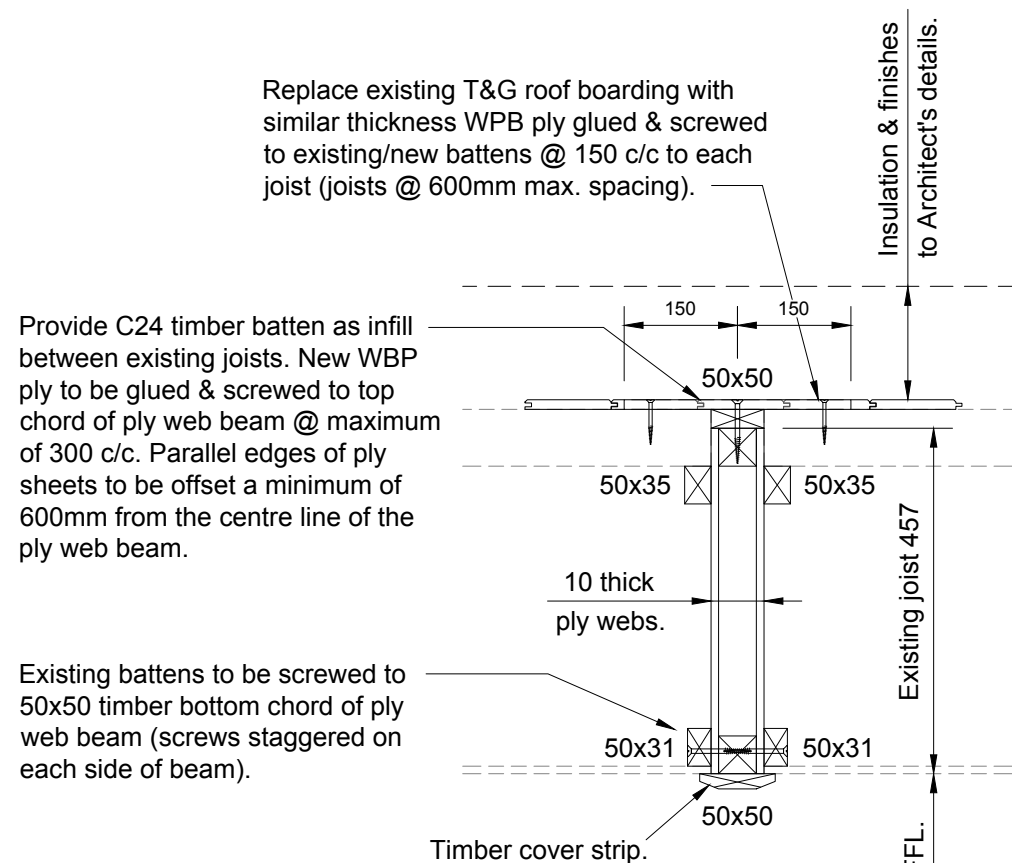

Section 1-1.
(Scale 1:10 @ A1).

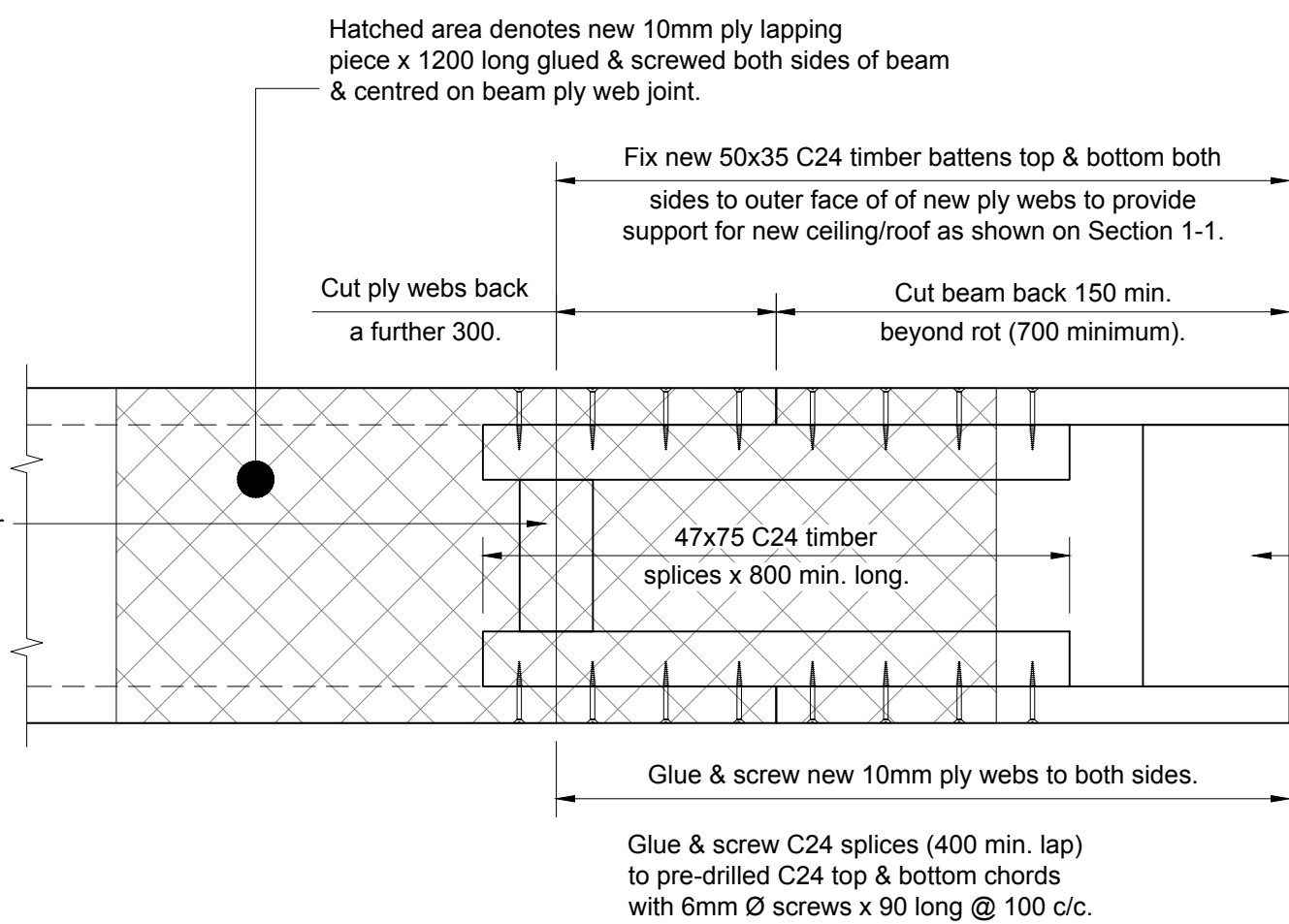

End Repair Detail for Ply Web Beams.
(Scale 1:10 @ A1).

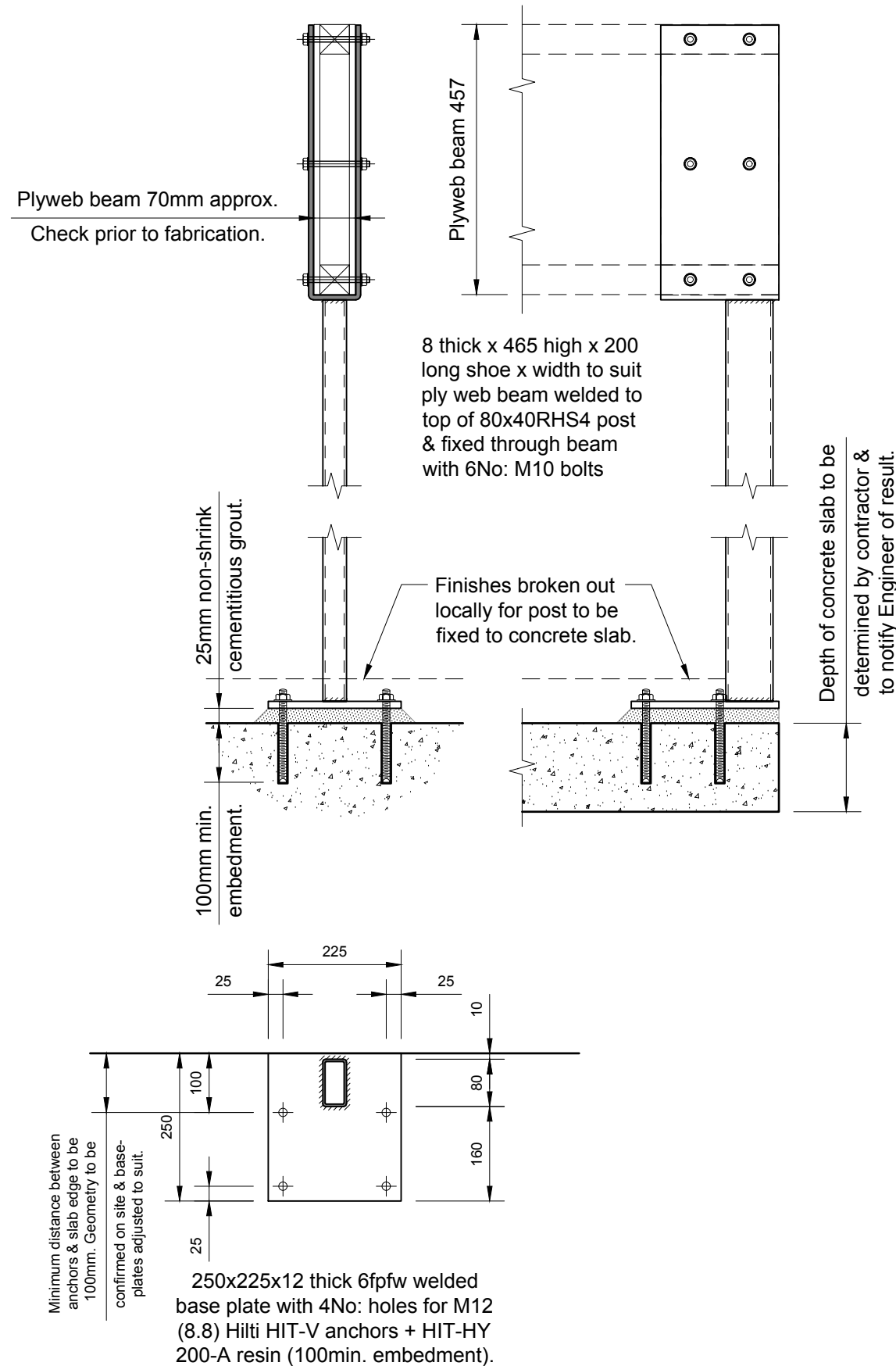

Post Details.
(Scale 1:10 @ A1).